

FARR 44



Design Specifications: Farr 44

Dimensions

Length overall	44'9"	13.54m
Waterline length	36'3"	11.04m
Beam	13'1"	3.99m
Displacement	16950 lb	7690 kb
Ballast	7550 lb	3425 kg
Draft L/K up	5'6"	1.67m
down	8'3"	2.50m
Draft F/K	7'4"	2.29m

Builder

McGaffin Boatbuilders Ltd.,
Auckland, NEW ZEALAND.

Designer

Bruce Farr & Associates,
Annapolis, Maryland.

Construction

Hull

Hand laid, woven KEVLAR and fibreglass cloth on either side of a 1" thick DIVINICELL foam core which is vacuum moulded to shape. Vinyl Ester resins are used throughout.

Transverse floors and frames are hand fitted to achieve the standards necessary to meet Bruce Farr's stringent strength requirements. Limber holes drain to a built in sump.

Deck

Hand laid, woven KEVLAR and fibreglass cloth on either side of varying thickness DIVINICELL foam core to achieve structural rigidity where required with minimum weights attained as a performance consideration.

Window and hatch cutouts are moulded into the deck for appearance and integrity.

Hull/Deck Joint

Deck is epoxy glued and screwed with bronze screws to a structural grade sole plate with structural

In the interests of weight and strength the stock is fabricated from two 316 stainless tubes fitted together, tapered and welded. The total diameter at the bottom bearing is a massive four inches.

Keel

External ballast is high antimony content lead for hardness, bolted to the hull with 316 stainless steel bolts. The shape is an extremely efficient section developed from Bruce Farr's considerable experience at the top level of international racing.

Steering

Standard is a 54" diameter wheel with a cable and quadrant drive system. Also standard is a fitting for emergency tiller steering.

Internally lit, pedestal mounted compass is standard.

Bulkheads

Bulkheads, which are structural throughout, are marine ply in the centre of the boat and foam cored KEVLAR for lightness at the bow and stern. Attachment is by hand applied tri-axial fibreglass tape.

Chainplates

Chainplates are electropolished, 316 stainless steel fittings, through bolted to a box girder structure and the main load carrying bulkhead.

Exterior Colours

Standard hull colour is white with off-white deck and cabin top to reduce reflection.

Royal Blue sheer stripe and boot topping.

Bottom Paint

Bottom paint is applied over a thoroughly cleaned and sanded under surface. The anti fouling applied is one coat of hard racing type.

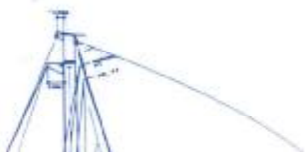

Machinery

Engine

Bukh, three cylinder, turbocharged, 48hp saildrive unit. Raw water cooled.

Engine Instruments

A recessed and covered instrument panel adjacent to the wheel provides tach/hour meter information plus all other necessary engine data.

Engine Controls

Single lever forward and reverse control mounted adjacent to the wheel.

Exhaust

Water cooled exhaust with fibreglass water trap muffler exits above the waterline through the transom.

Propellor

Two bladed, folding propellor is standard.

Fuel System

Fuel is contained in two fuel tanks with a total capacity of 70 gallons.

Electrical

A.C. 110v

Shore power is provided at outlets in the galley, navigation station and both toilets.

D.C. 12v

D.C. power is provided by one engine starting battery and two high capacity ships batteries. Battery systems are charged automatically on demand by the engine driven alternator or by shore powered battery charger. Switching is provided to select either battery or total power isolation as required.

Main Electrical Panel

All controls and monitoring functions are provided on a master panel at the navigation. Circuitry is provided for all normal functions on a boat of this quality.

Deck is epoxy glued and screwed with bronze screws to a substantial gunwale strip with structural integrity and waterproofing assured by the hand application of tri-axial fibreglass doubler over the joint.

Rudder

Hand laid KEVLAR and fibreglass over a high density foam core. The shape is developed from the latest hydro-dynamic information available and has been proven on Bruce Farr's current, very successful, racing designs.

A master panel at the navigation console is provided for all normal functions on a boat of this quality with spare circuits available. The master panel has A.C. and D.C. volt and ampmeters with a polarity indicator on the A.C. input circuit. All circuits, A.C. and D.C., are protected by resettable circuit breakers with a double pole circuit breaker provided to protect the primary A.C. input.

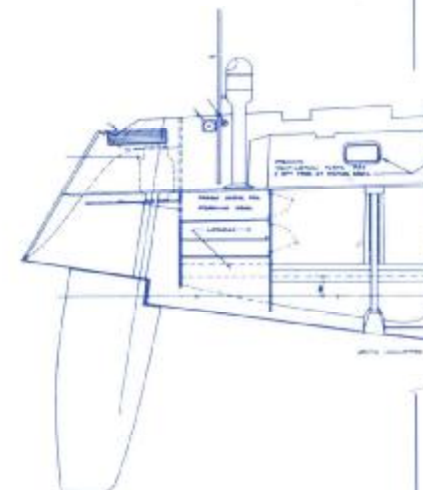
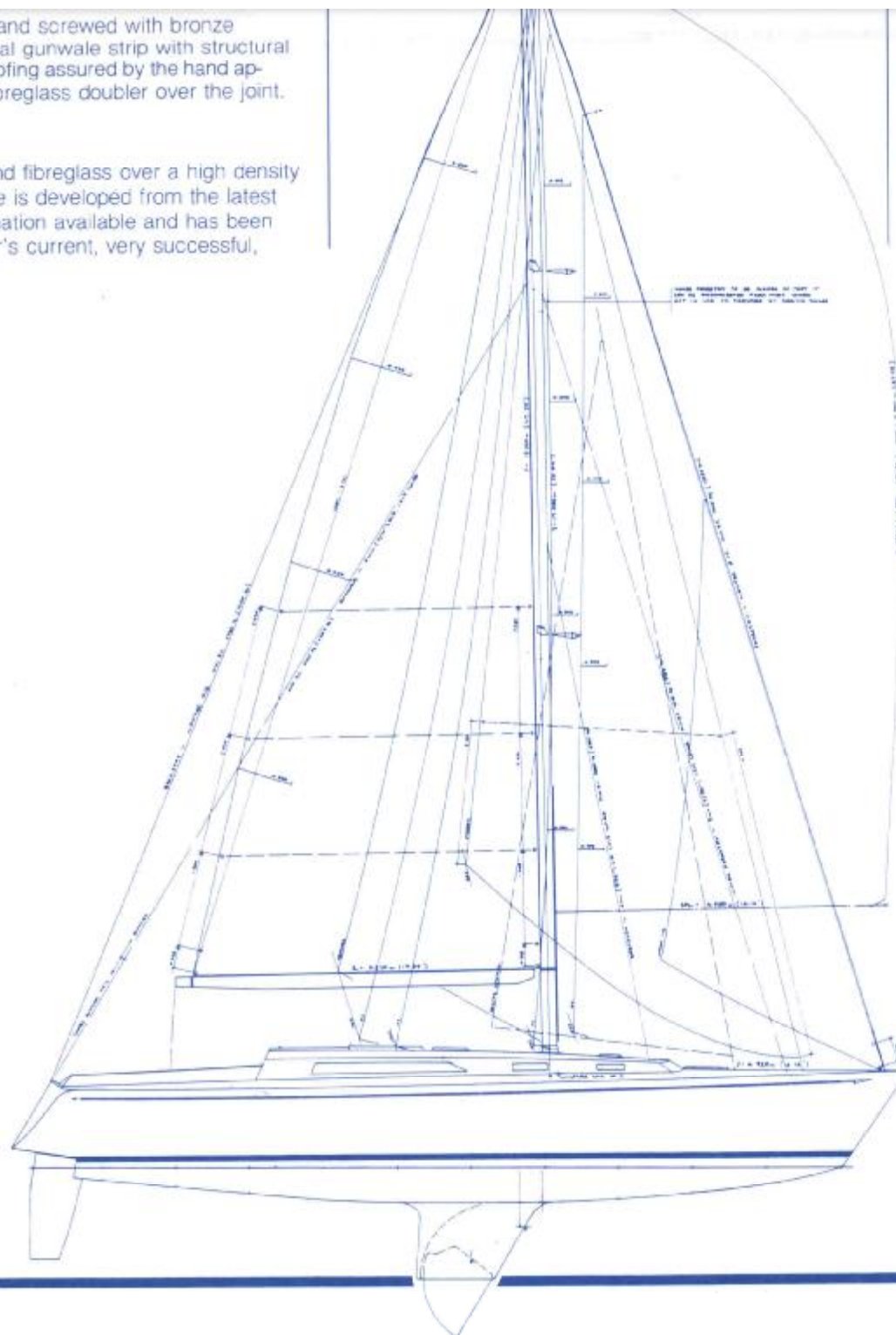

Battery Charger

20 amp automatic.

Interior Lighting

Lighting is provided by incandescent overhead lights in both heads, all cabins, galley and navigation area with a flexible light over the navigation table.

Exterior Lighting

Navigation lighting is provided by a masthead mounted, high intensity, tri-axial unit which also houses the anchor light. The bow is floodlit by a mast mounted unit.

Stereo

Wiring is provided for stereo speakers to be installed in pairs in the forward cabin, main cabin, aft cabin and cockpit.

Plumbing

Water

Fresh water is contained in two 60 gallon stainless steel tanks, properly baffled and vented. Pressure hot and cold water is provided at aft head and shower as well as at both galley sinks. Pressure cold water is provided at the forward head sink. Hand pumps supply fresh water to both heads and salt water to the galley sinks.

Shower

The aft head is provided with a moulded shower base and sump with a personal shower head. Water is heated by 110v shore power or by engine heat exchanger.

Interior

Joinery Work

All interior panelling is NEW ZEALAND Kauri timber tongue and groove, contrasted with Teak trim. Bench tops in galley and heads are Formica covered, with waist high Formica panelling in both heads. All locker doors are louvered for ventilation and appearance with positive locks provided on all doors and drawers. Surfaces are satin varnished to achieve a finish that matches and enhances the obvious quality of the joinery. The cabin sole is contrasting Teak and holly timber strips with all floor panels edged in Teak trim. All visible areas of the hull are lined with horizontal Kauri strip panelling of the highest standard.

Upholstery

Variable density foam is used throughout to give comfort and firmness where needed. Bases are formed from 4" thick pads and shaped for maximum support. In the main cabin backrests are foam formed to shape a curved back to both settees. These settees can be installed with the facility to extend the width for greater sleeping comfort. Highest quality fabrics are used throughout with an almost unlimited choice of colour and pattern.

Cooking

A three burner MARINER L.P.G. stove and oven is installed with gimballed movement for use whilst under way. An immediately accessible shutoff switch actuates a bottle mounted solenoid valve with open/close indication provided by a warning light adjacent to the stove. Gas bottle storage is in a vented locker aft of the steering position.

Deck

Hatches

All deck hatches are top quality LEWMAR with tinted plastic. Three of 10"x10" over galley and both heads, one of 24"x24" in foredeck, one of 19"x19" over centre of main cabin.

The main sliding access hatch is fabricated using Teak surround and slide rails with curved Teak spray dodger attachment fitted if required.

Opening Ports & Ventilation

3 opening ports with insect screens are fitted in the cockpit to ventilate the rear cabin and two flush mounted, suction vents are mounted on the cabin top.

Mooring Attachment

6 bow, stern and spring cleats are provided. All adequately fastened.

Stem Fitting & Anchor Well

Stem fitting is welded stainless steel with a ground tackle roller integral in the unit. The large capacity anchor well is covered with double, side opening, lids with provision for mounting an anchor winch if required.

Toe Rail & Lifelines

A Teak, hand formed, toe rail is fitted, as are 26" high stainless stanchions. Bow and stern rails are stainless tubing with intermediate rails fitted. The two piece stern rail unit may be fitted with a gate for access to the stern boarding platform, if fitted. A lifeline gate is provided on which ever side is preferred by the client. Top wire is P.V.C. coated. Provision for two horse-shoe buoys is fitted on the stern rails.

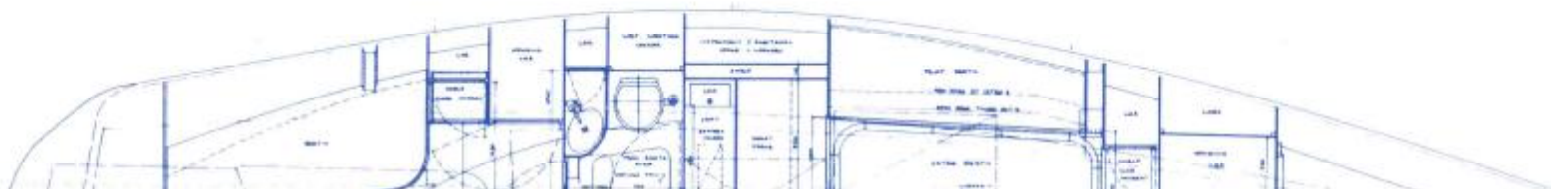

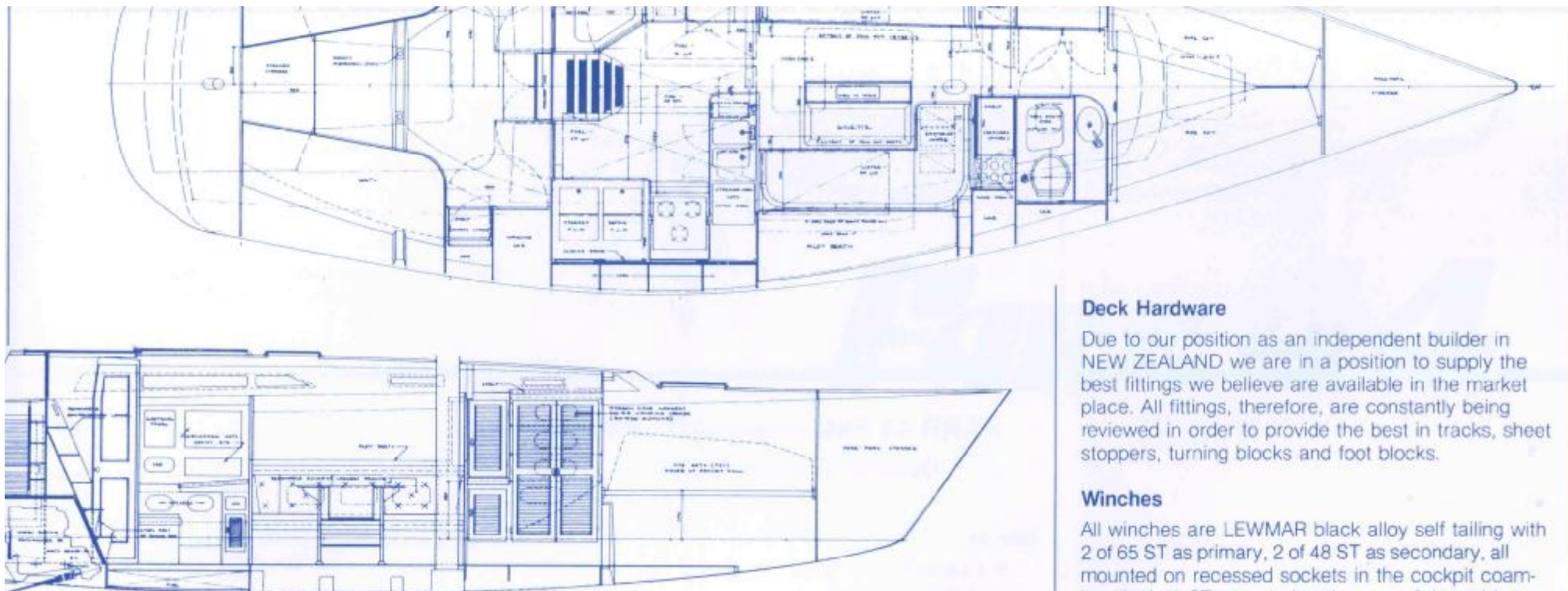

Waste System

Two hand operated water closets each with a 15 gallon flexible holding tank fitted. 'Y' valve selection permits holding tank use or direct discharge as desired. A deck fitting allows connection for dockside pump out.

Bilge Pump System

Sump in hull has high capacity electric bilge pump connection plus hoses for internal and externally mounted hand operated bilge pumps.

Hull Inlet and Outlets

All fittings are flush mounted bronze with gate valves at all appropriate points.

Cold Storage

12 cubic feet of storage is provided in a stainless steel lined, two compartment, shelved ice box. Insulation is provided by 4" of polyurethane foam.

Hand Rails

Teak hand rails are provided on the deck head in strategic areas.

Deck Hardware

Due to our position as an independent builder in NEW ZEALAND we are in a position to supply the best fittings we believe are available in the market place. All fittings, therefore, are constantly being reviewed in order to provide the best in tracks, sheet stoppers, turning blocks and foot blocks.

Winches

All winches are LEWMAR black alloy self tailing with 2 of 65 ST as primary, 2 of 48 ST as secondary, all mounted on recessed sockets in the cockpit coaming. 2 of 40 ST mounted at the rear of the cabin top and 4 of 46 ST mounted adjacent to the mast for halyard control. Four handles are provided.

FARR 44

Spars and Rigging

Mast & Boom

Extruded, tapered aluminum with white reaction lacquer as standard finish. All halyards are internal with provision for 1 main, 1 genoa, 2 combination spinnaker/genoa, 1 spinnaker topping lift, and 2 reef lines. Wiring tube with chasers is provided to install wiring for mast mounted instruments and aerials. Boom is deep sided 'jumbo' type with provision for hydraulic outhaul and main flattener.

If desired all sheaves in mast and boom may be low friction roller bearing type at extra cost.

Hydraulic System

Vertex multi-function hydraulic panel handles backstay, boom vang, and combination outhaul/flattener. Mounted adjacent to wheel.

Standing Rigging

Nitronic stainless steel rod rigging with NEW ZEALAND developed 'GRAHAM' end fittings. Adjustable running backstay and baby stay are provided.

Running Rigging

Braided Dacron sheets with rope/wire halyards. Main halyard, main cunningham, 1 genoa, 1 combination genoa/spinnaker, main sheet, main traveller control, genoa cunningham and 2 genoa sheets are standard.

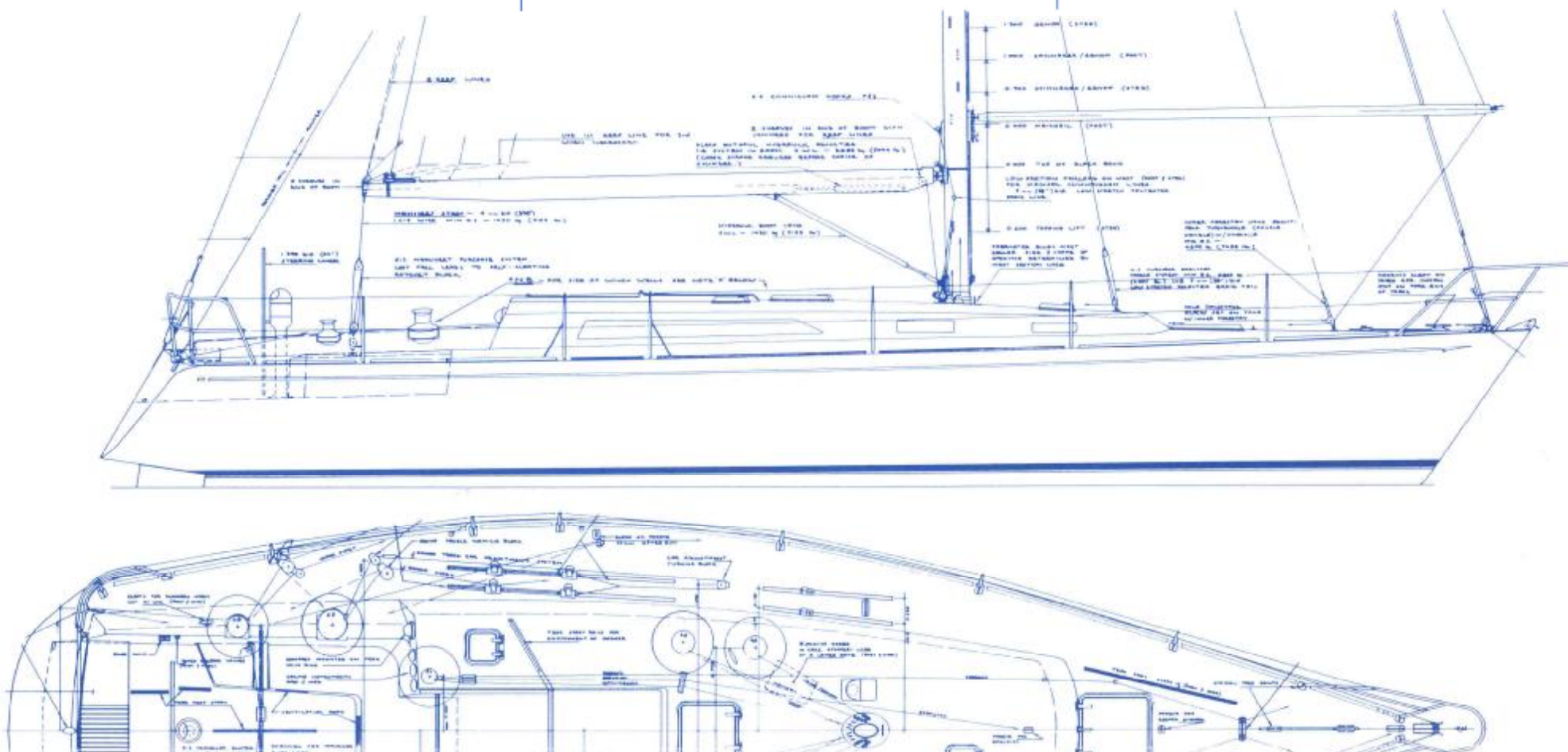

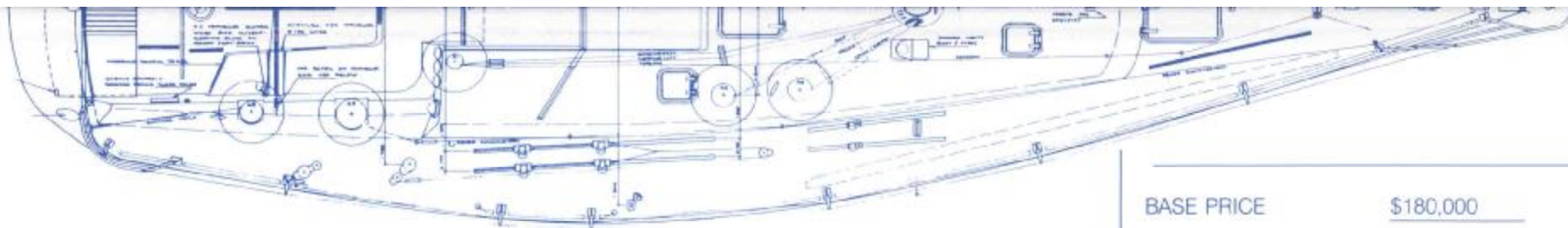

BASE PRICE \$180,000

NOTE — Prices and specifications subject to change without prior notification.

FARR 44 Fast Cruising Yacht

Optional Equipment List

Hull & Deck

Hydraulically operated lift keel	\$5,600
*Hydraulic vang, backstay, outhaul/flattener	4,500
*Striping & basic sign writing	420
Colour & graphics of choice	P.O.A.
Stern boarding platform	1,120
Danboug stowage in transom	224
Laid teak — Deck, cockpit and seats	4,480
Teak toe rail	1,500
*Electric anchor windlass	1,680
*Ground tackle — 44 lb Bruce, chain, warp	504
Spray dodger & teak fairing	660
Leather bound wheel	224
*Shaped helmsmans seat & liferaft cover	560
*Lifeline gate	168
Cockpit opening vents (3)	436
S/S boarding ladder	450

Rig & Sails — See attached list

Spinnaker package — Includes: Two poles, wire/rope halyard & snap shackle, two foreguys & blocks, topping lift, two sets sheets & afterguys & snap shackles, turning blocks plus secondary winches	6,720
--	-------

Interior

Fwd pipe berths & stowage	560
Teak & Holly cabin sole	1,120
Total refrigeration — Engine & 10v	3,640
Fwd shower and sliding door	1,680
*Aft shower	750
Pressure & heated water	1,120
*Shore power — 110v & battery charger	1,008
Superior quality squab covering	280
Gimballed oven & surround	840
*Dual 12v electrical circuitry	224
Extra gas bottle & stowage	84
Extended range fuel tanks	336
Extra capacity water tanks	448
Complete set color co-ordinated bunk sheets (flat & fitted), pillows & cases, 12 matching cushions	500
Stereo — 3 cabins & cockpit	896
Electronics as requested	P.O.A.

Handling

Transportation charges — includes insurance, subject to confirmation by shipping company	14,560
--	--------

*Items not included in basic price but normally installed by builder during construction.

Sails (Hood NZ.)

Prices may vary from other sailmakers.

Main

3 reefs	9.1 oz	1875
Trisail	11.0 oz	442

Genoas

No. 1 Heavy	4.5 oz	2096
No. 1 Light	2.8 oz	2028
No. 2	8.7 oz	1538
No. 3	5.4 oz (2 ply)	1536
No. 4	10.3 oz	1064
Storm Jib	11.0 oz	463

Reacher

4.4 oz	1578
--------	------

Spinnakers

Tri radial	1.2 oz	1727
Tri radial	.75 oz	1727
Reaching spinnaker	1.5 oz	1727
Flanker	2.2 oz	2448
MPS	1.5 oz	1263

Main and Boom Cover

176

Boat Cover

632

Cockpit Awning

190

Designed By
Bruce Farr & Associates, Inc.

Marketed By
Farr International

Built By
McGaffin Boat Builders

McGAFFIN BOATBUILDERS LTD.
Builders of Yachts — Launches

Repairs Maintenance and Refitting

P.O. Box 62077
Sylvia Park
Mt. Wellington
New Zealand



26 Bowden Road
Mt. Wellington
New Zealand
Ph. 573-383