

To create a truly magnificent sailing yacht combined with exhilarating performance requires the successful collaboration of a wide variety of specialists. Bruce Farr, from the finest New Zealand racing heritage, was appointed to design the hull and Nauta Yachts; from Milan, applied years of experience into their innovative and stylish deck and interior layout design. The world-renowned Sangermani shipyard constructed *Desirade* using the most advanced materials. In addition, the latest navigation technology and superb level of craftsmanship makes *Desirade* one of the finest yachts of her size ever built.







The exterior is well designed, with a superb dedicated cockpit where the guests can dine; under a removable sun awning if required, or use this area for sunbathing and general relaxation. The aft cockpit, from where the crew control this remarkable yacht, can be used to either relax and watch the world go by or, for those that may feel more adventurous, to take the helm and experience the ultimate thrill of sailing *Desirade*.









Even for the most discerning and experienced charter guests, *Desirade* surpasses all expectations. Eight guests are accommodated in four en-suite cabins including a full-width master stateroom. The deck house provides panoramic views while under sail or relaxing at anchor. Three steps below is the full-width saloon with a large dining table and a very cosy L-shaped seating area opposite. Top quality fabrics and furnishings combine with the finest Burma teak to create an ambience that is both light and airy and of the highest quality.





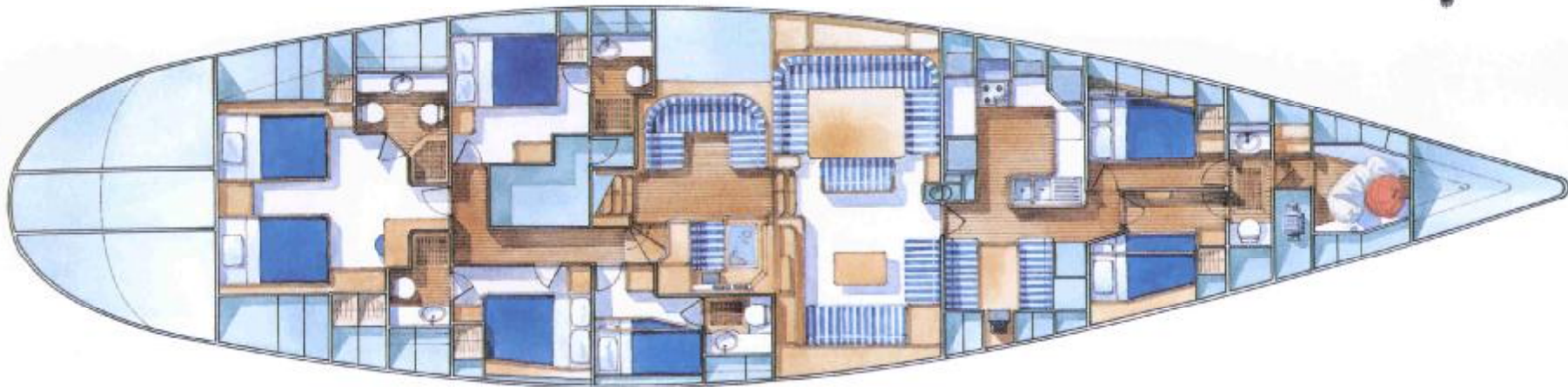

Sailing equipment: Hydraulic winches • Hydraulic rollaway system for staysail, genoa and yankee • Autopilot • Radar • GPS • Chart plotter • Weather fax

Water sports: 4,2m Zodiac tender with 40hp Evinrude outboard and a 15hp outboard • Water skis • Inflatable doughnut • Kneeboard • 10 sets of masks and flippers (various sizes) • Basic fishing equipment • Side-mounted swimming ladder and a fresh water deck shower • Sun awnings for cockpit

Entertainment: Each cabin has its own Alpine stereo with CD player • Main saloon has a Phillips multi-system TV with JVC multi-system video player • A large selection of English and Italian video's • The main saloon has an Alpine stereo with a 12 disc CD changer with tape player • Pilot house speakers selectable from saloon stereo • Cockpits have two 90-watt speakers each selectable from the saloon stereo • Board games: Tombola, Pictionary, Monopoly, Cards, Chess • Various computer games suitable for adults and children.

Communication equipment: Inmarsat C Satcom system • Cellular phone • SSB and VHF radio

Dimensions

Length	28 m	92 ft
Beam	6.8 m	22 ft
Draft	3.6 m	12 ft
Mastheight	38 m	124 ft
Sail Area	356 m ²	3832 ft ²
Displacement	60 tons	

Engineering

Construction	composite
Main engine	Man 400 hp
Generators	Onan 2 x 16 kw
Fuel tanks	5,600 l
Watertanks	1,200 l
Watermakers	2 x 180 l/hr
Air Conditioning	Condaria

Builders

Cantieri Sangermani, Lavagna from the drawing boards of naval architects Bruce Farr and Nauta Yachts design group for exterior and interior styling and layout.



S P E C I F I C A T I O N



AGENTS STAMP

art direction *Nauta Yachts*
graphic project *Paola Greco*
photo *Roberto Franzoni*