

# BENETEAU FIRST 47.7

Life without compromise.

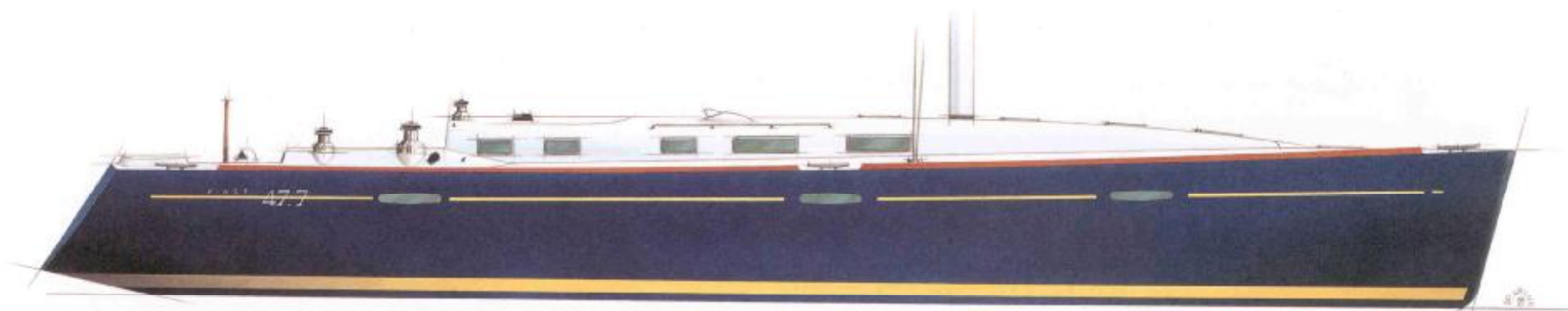

 BENETEAU

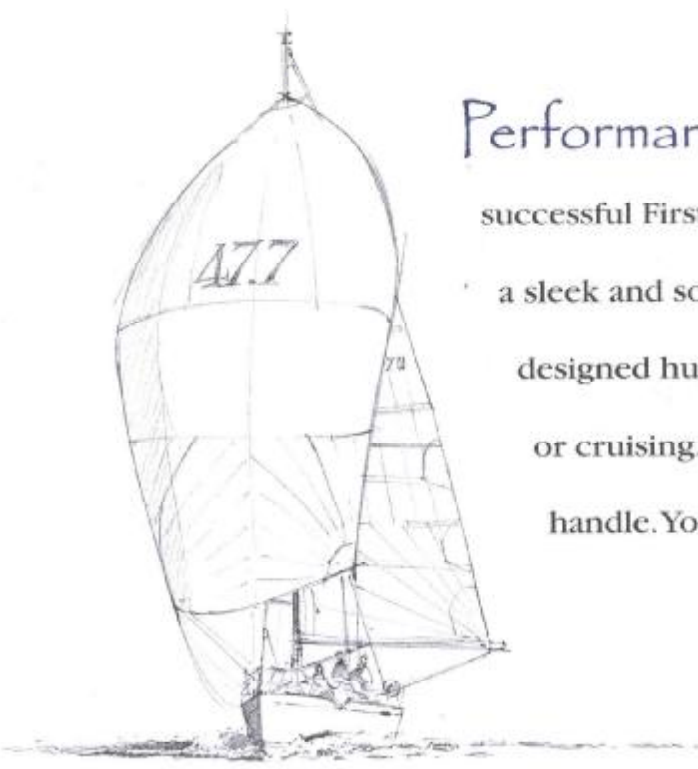

Performance without limits. Following in the footsteps of the highly successful First 40.7 and the interior styling of the First 45f5, the new First 47.7 combines a sleek and sophisticated racer with all the comforts of a luxurious cruiser. Her Bruce Farr designed hull and powerful rig provide excellent performance, whether you're racing or cruising. Impeccable in detail and elegant in design, the 47.7 is fast, fun and easy to handle. You have a choice of two rigs - racing or cruising - and three keels.

Whether raced equipped to go offshore or around the buoys, the 47.7 will be showing her transom to the competition.

Below decks, you have the option of choosing a 2, 3 or 4-cabin layout. Each configuration has large berths, hanging closets, and functional lighting. The nav station faces forward with a large chart table and pigeon-hole chart storage. The galley is fully equipped with a large front loading refrigerator, 2-burner stove and loads of counter space. All of this is combined with custom cabinetry and the exceptional interior joinery that is the Beneteau signature. As with all boats in the Beneteau family, the First 47.7 provides exceptional quality, performance and value.

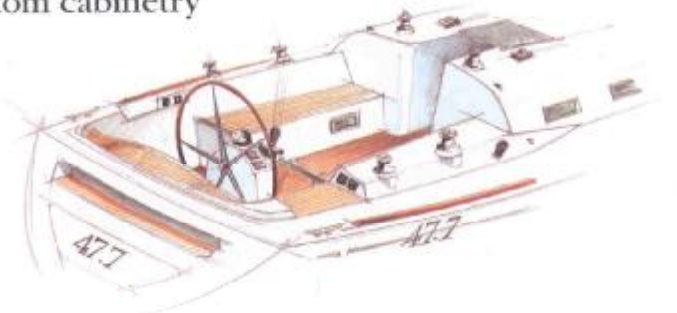

Details designed to meet the high demands of the sophisticated sailor.

The cockpit design is extraordinary. The large wheel allows the helmsman to sit comfortably on the coaming with an unobstructed view forward.

Features include teak slatted inlaid seats and plenty of room to mount electronics on the steering pedestal and cockpit coaming. The traveler is conveniently located near the helm for optimal boom and mainsheet control.

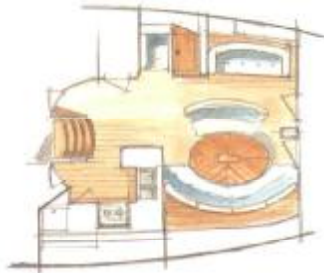

The plush interior offers many exquisite details. The warm tones of cherry stained interior greet you as you enter the salon and there is plenty of ventilation accentuated by the 6'4" feet of headroom. Luxurious appointments include handrails sheathed in leather, a gimballed salon table that can be tilted when heeling, and companionway steps framed with aluminum.

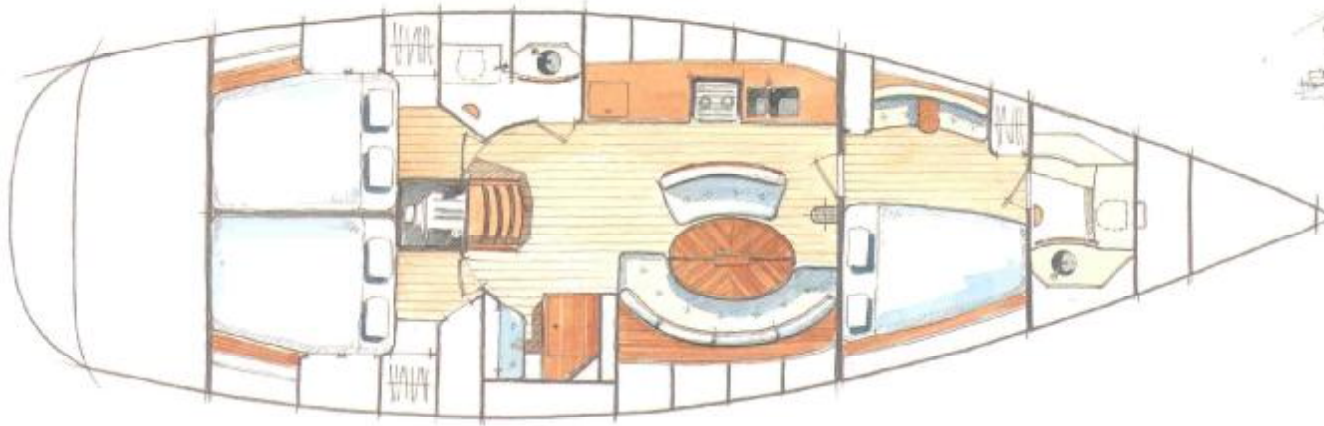

## BENETEAU FIRST 47.7 SPECIFICATIONS

LOA.....47'7"  
 LWL.....41'4"  
 Beam.....14'9"  
 Draft.....deep/bulb.....9'2".....shoal/wing.....7'7"  
 Displacement.....25,353 lbs (approx)  
 Ballast.....8,377 lbs (approx)  
 Std Sail Area.....1,324 sq ft (100%)

Hull Design: FARR YACHT DESIGN LTD.

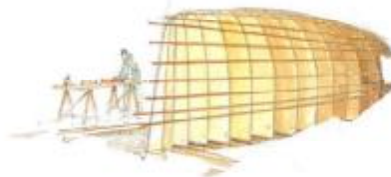

The Sea Demands The Best

1884 - 2000

Beneteau USA 24 North Market Street Charleston, South Carolina 29401  
 telephone 843-805-5000 fax 843-805-5010 [www.beneteauusa.com](http://www.beneteauusa.com)

*The manufacturer reserves the right to alter equipment and specifications without notice. All specifications are approximations and are not contractual in nature.*